

# Instruction Manual

## 2CH Smart Switch

# EUROSPOT

SKU: 6241

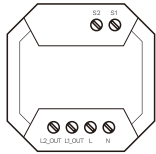

## Technical Specification

Input	AC100-240V/50-60Hz/16A Max
Output	AC100-240V/50-60Hz/8A*2 Max
Ta	-20~45°C
Operation Range	<100M
IP Rate	Ip20
Warranty	3 years
Certificates	CE ROHS Reach
Dims	46.5*46.5*24mm

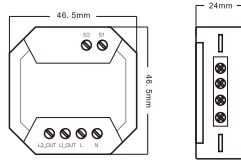

## Indicating Light Function

OFF	Blinking	ON
Linked to Network	Linking Status	Disconnect

## SET Button Function

Short Press	Long Press
Switch Output Status	Configuring Network

## Configuring Method

1. Long press SET button for over 5seconds until indicating light ON, the switch come into Linking Status.
2. Switch ON-OFF power 5 times(ON-OFF-ON-OFF-ON-OFF-ON-OFF-ON) until indicating light ON, the switch come into Linking Status.

## Application

Global international operation whenever&wherever you are, All-in-one smartphone.



## Warnings:

1. Installation must be carried out by a qualified electrician in accordance with local regulations.
2. Keep the device out of reach of children.
3. Keep the device away from water, damp or hot environment.
4. Install the device away from strong signal sources such as microwave oven that may cause signal interruption resulted to abnormal operation of the device.
5. Obstruction by concrete wall or metallic materials may reduce the effective operation range of the device and should be avoided.
6. Do not attempt to disassemble, repair or modify the device.

## FAQ

Q1: what should I do if I can't configure the switch?

- A. Please check whether device is powered on.
- B. Make sure your mobile phone and switch are under the same 2.4GHz WiFi network.
- C. Whether it's in good internet conditions.
- D. Make sure the password entered in App is correct.
- E. Make sure the wiring is correct.

## Wiring Instructions and Diagram

1. Turn OFF the power before carrying out any electrical installation work.
2. Connect wires according to the wiring diagram.
3. Insert the switch into the junction box.
4. Turn ON the power and follow the smart switch configuration instructions.

Notes: Take your smartphone close to the switch when you are configuring, and make sure you have over 50% WiFi signal.

### Single Control Wiring Diagram

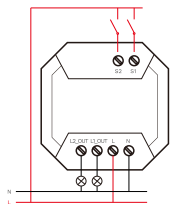

### Double Switch Wiring Diagram

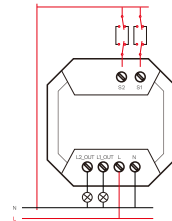

### Without Switch Wiring Diagram

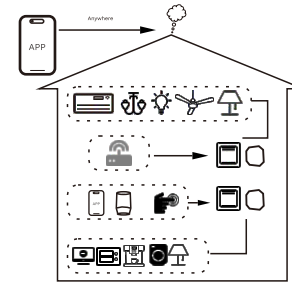
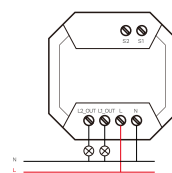

Q2: What device can be connected to this WiFi smart switch? Most of your household electrical appliances can be, such as lamps, laundry machine, coffee maker, etc.

Q3: What happens if the WiFi goes off? You can still control the device connected the smart switch with your traditional switch and once the WiFi is active again, the device connected to the smart switch will connect automatically to your WiFi network.

Q4: What should I do if I change the WiFi network or change the password? You have to re-connect our WiFi smart switch to the new WiFi network according to the APP User Manual.

### Inhouse local operation

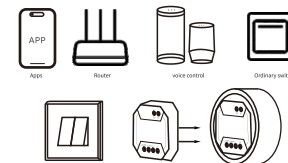



1

Scan the QR code to download the Tuya "Smart Life" APP or you can search keyword "Smart Life" on APP store or Google play to download the APP.

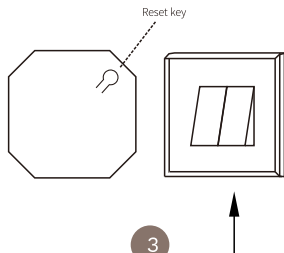

3

After the wiring of the smart switch is done, long press the "SET" button for 5 seconds or switch ON-OFF the traditional switch 5 times until the indicating light ON.

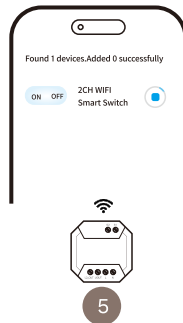

5

The connecting will take about 10-120 seconds to complete depending on your network condition.

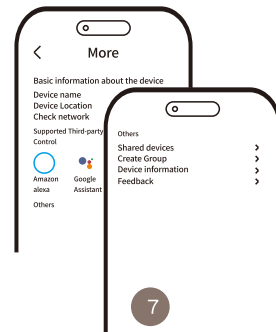

7

Connect to Amazon Alexa or Google Assistance for voice control, or share the devices with your families and friends.



2

Log in or register your account with your mobile phone number or email address.

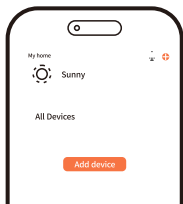

4

Open the log-in APP, click "Add Device" or "+" on the right top of corner. It will automatically discover the device.



6

Finally, you can control the device via your mobile phone.